

REVISIONS				
ZONE	REV	DESCRIPTION	DATE	APPROVED

Top Centering Ring

Used as top ring in both 1st and 2nd stage fin frames.

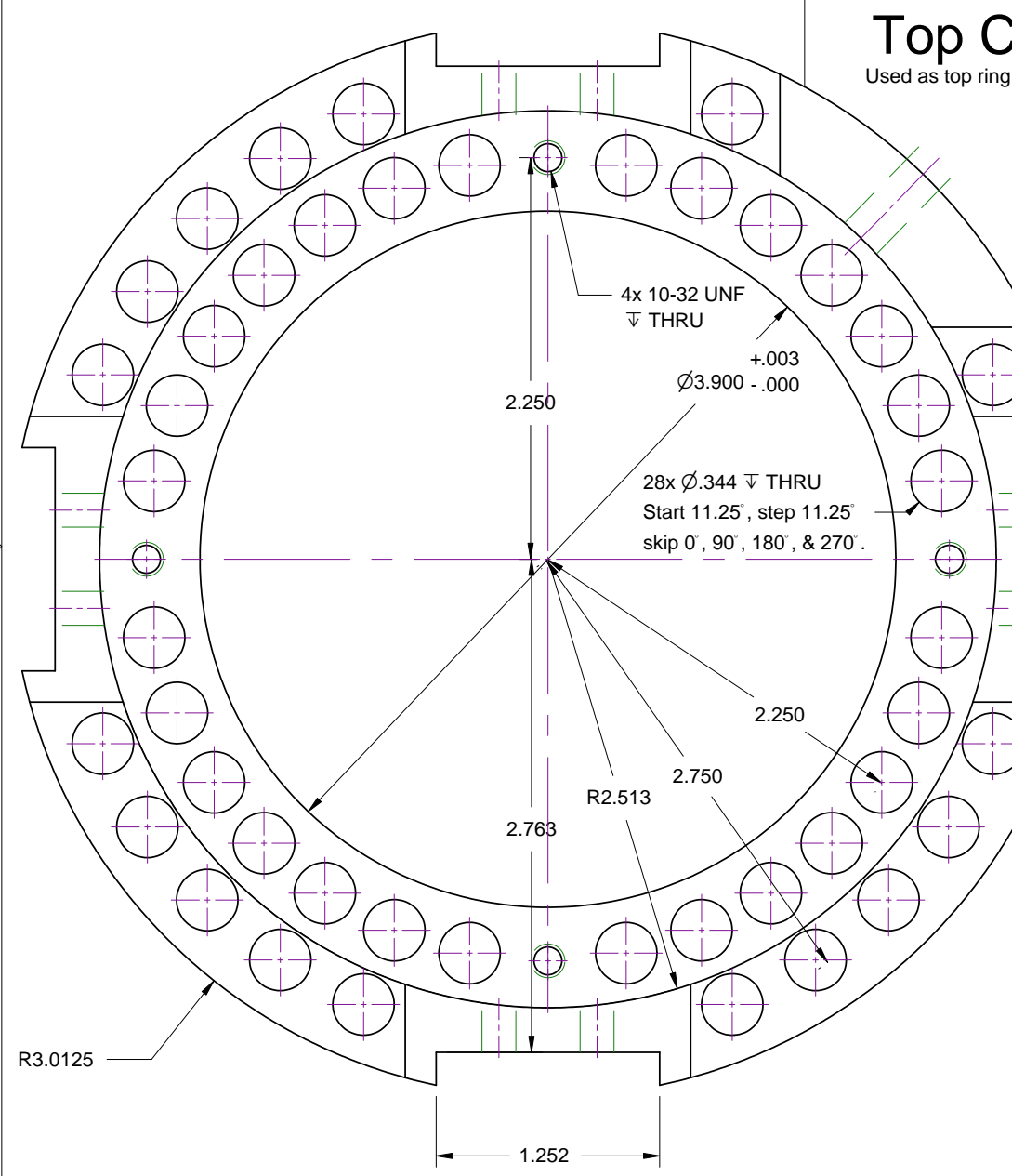

17x $\phi .344$ ▽ THRU
Holes at 22.5°, and 67.5°,
112.5° to 157.5° step by 11.25°,
-22.5° to -67.5° by -11.25°,
-112.5° to -157.5° by -11.25°.

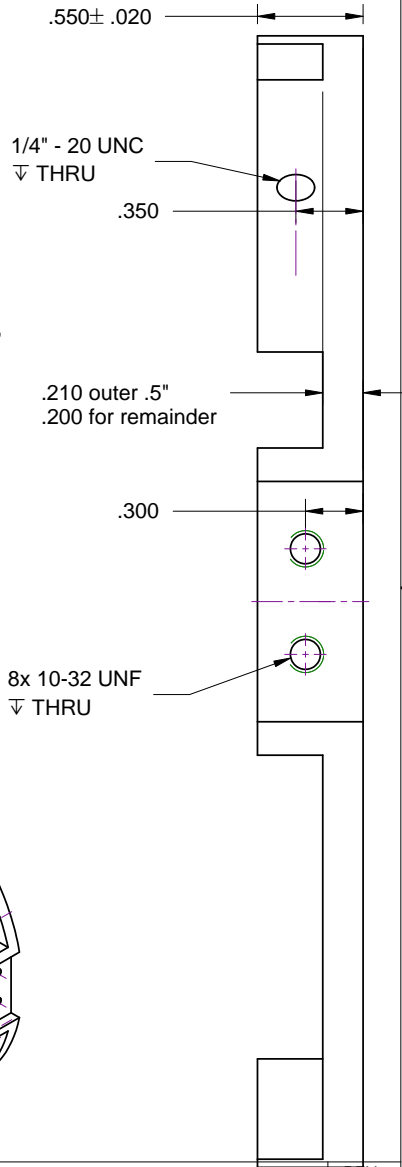
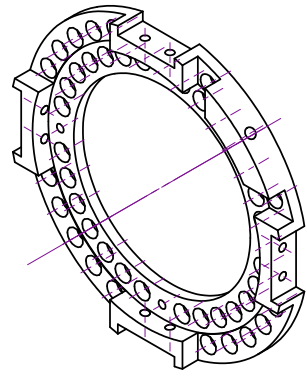

SIZE A	FSCM NO.	DWG NO.	REV
SCALE	B. Feretich & G. Saviers		SHEET

REVISIONS				
ZONE	REV	DESCRIPTION	DATE	APPROVED

Top Centering Ring

(Milled Pockets)

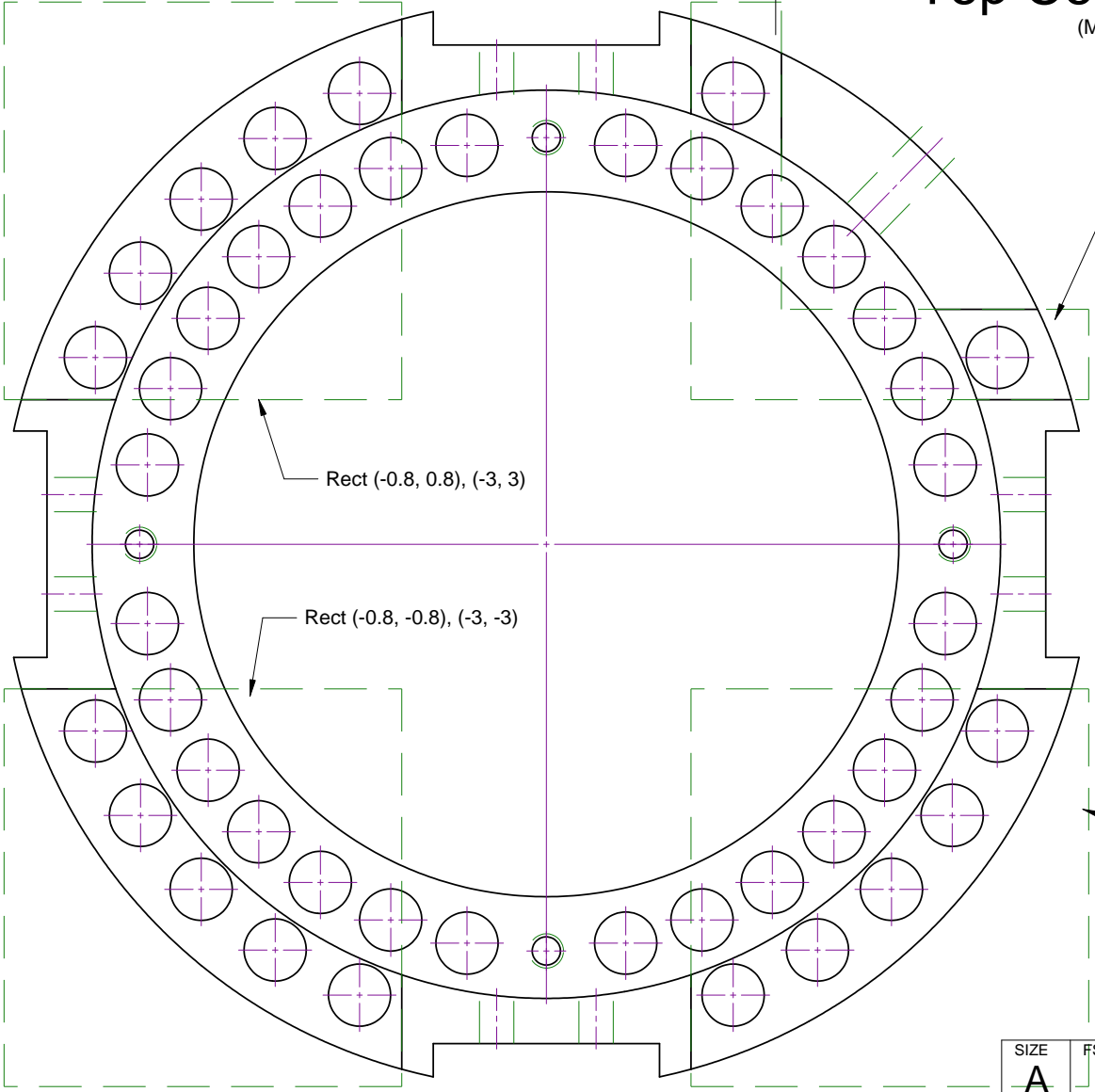

Shape (0.8, 0.8), (3, 0.8), (3, 1.3), (1.3, 1.3), (1.3, 3), (0.8, 3)

Rect (-0.8, 0.8), (-3, 3)

Rect (-0.8, -0.8), (-3, -3)

All milled pockets are machined to +0.1 above the inner ring surface.

Rect (0.8, -0.8), (3, -3)

SIZE A	FSCM NO.	DWG NO.	REV
SCALE	B. Feretich & G. Saviers		SHEET